

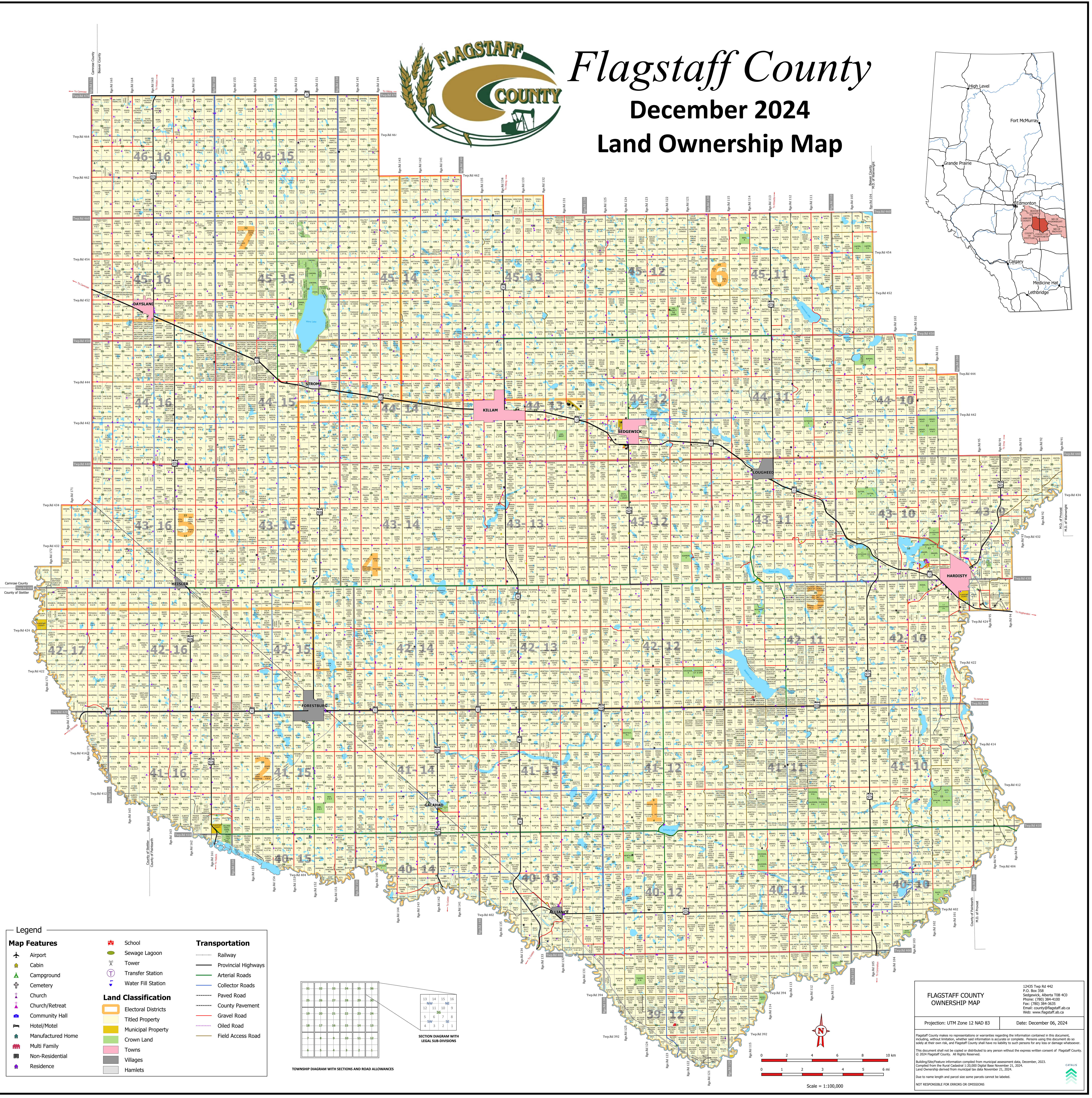

Flagstaff County

December 2024

Land Ownership Map

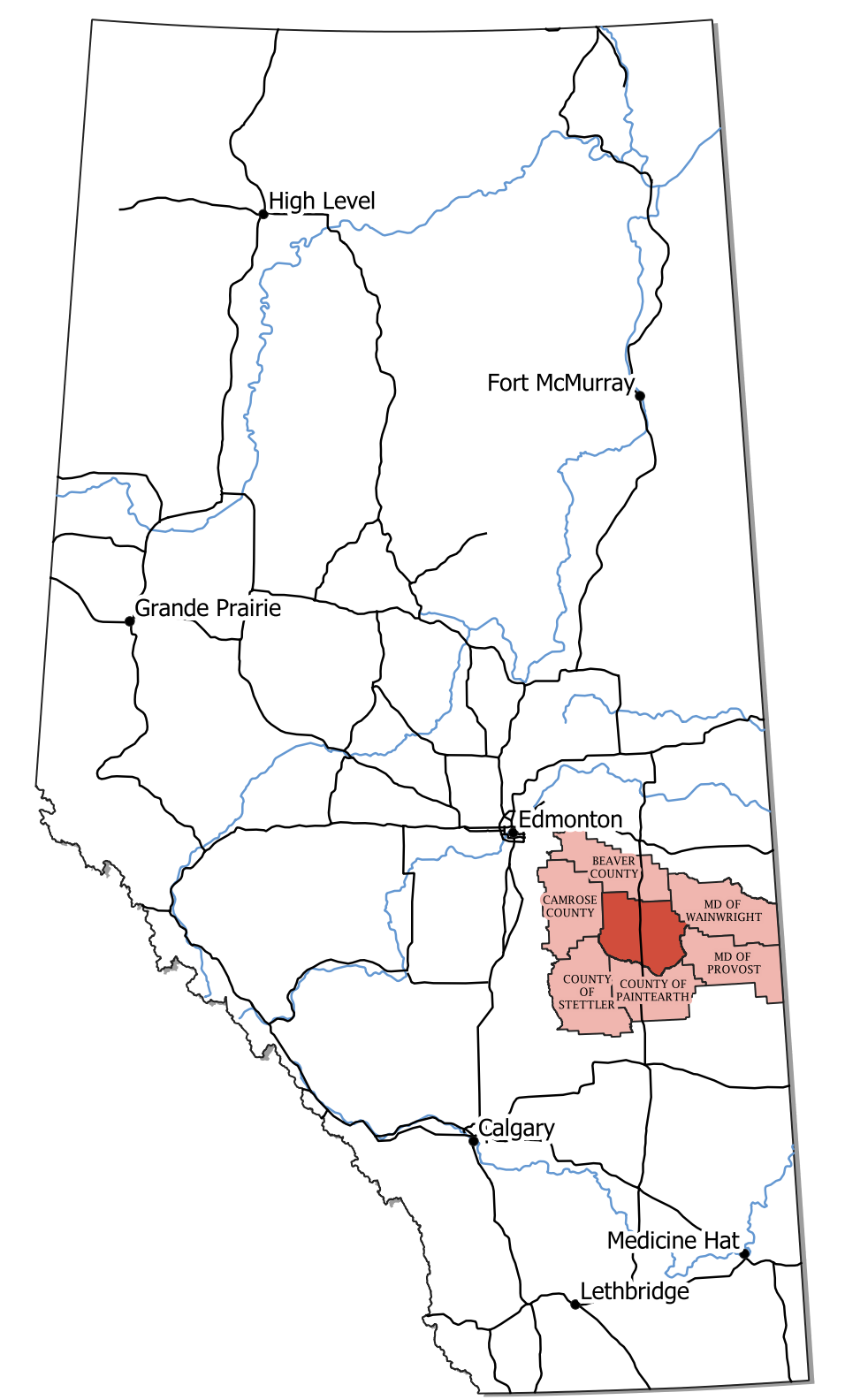

Legend

Map Features	School	Sewage Lagoon	Railway
Cabin	Tower	Transfer Station	Provincial Highways
Campground	Water Fill Station	Arterial Roads	Collector Roads
Cemetery		Paved Road	County Pavement
Church		Gravel Road	Oiled Road
Church/Retreat		Field Access Road	
Community Hall	Land Classification	Electorat Districts	
Hotel/Motel	Titled Property	Municipal Property	
Manufactured Home	Crown Land	Towns	
Multi Family	Villages	Hamlets	
Non-Residential			
Residence			

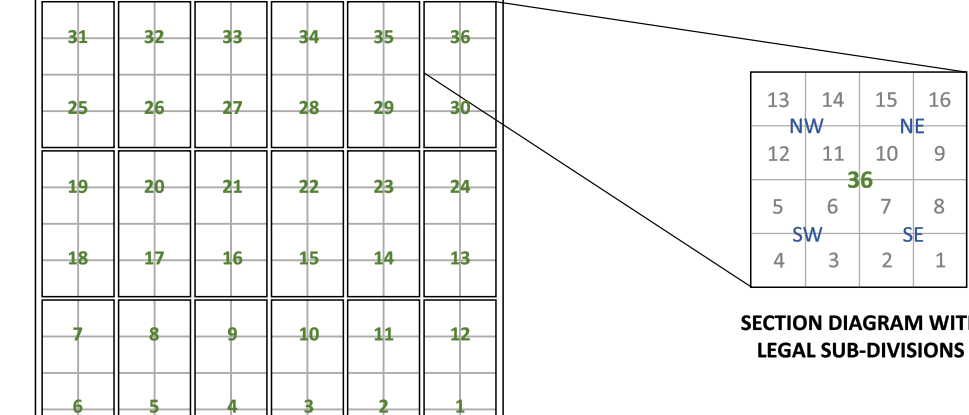

TOWNSHIP DIAGRAM WITH SECTIONS AND ROAD ALLOWANCES

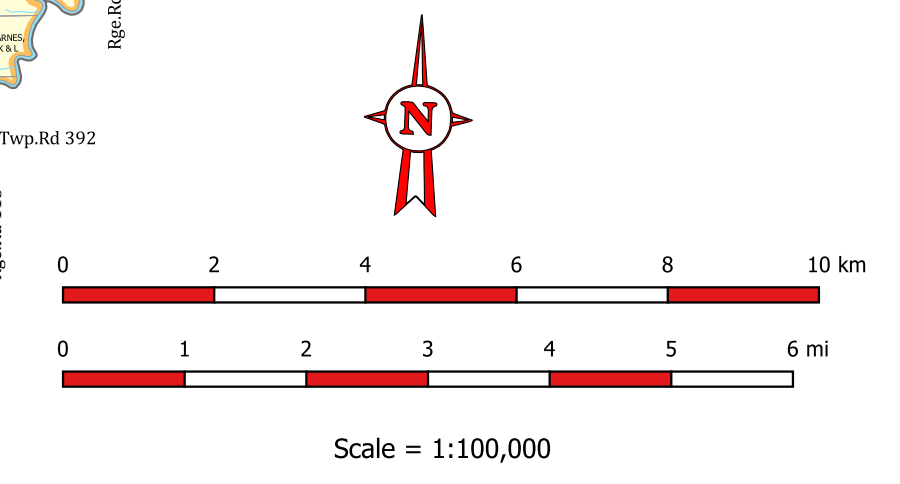

FLAGSTAFF COUNTY OWNERSHIP MAP

12435 Twp Rd 442
P.O. Box 358
Sedgewick, Alberta T0B 4C0
Phone: (780) 384-4100
Fax: (780) 384-3635
Email: county@flagstaff.ab.ca
Web: www.flagstaff.ab.ca

Projection: UTM Zone 12 NAD 83 Date: December 06, 2024

Flagstaff County makes no representations or warranties regarding the information contained in this document, including, without limitation, whether said information is accurate or complete. Persons using this document do so solely at their own risk, and Flagstaff County shall have no liability to such persons for any loss or damage whatsoever.

This document shall not be copied or distributed to any person without the express written consent of Flagstaff County. © 2024 Flagstaff County. All Rights Reserved.

Building/Structure information compiled from municipal assessment data, December, 2023.
Compiled from the Rural Cadastre 1:20,000 Digital Base November 21, 2024.
Land Ownership derived from municipal tax data November 21, 2024.

Due to name length and parcel size some parcels cannot be labelled.

NOT RESPONSIBLE FOR ERRORS OR OMISSIONS